

# 13.345.24

## ● Outline drawing Searchlight

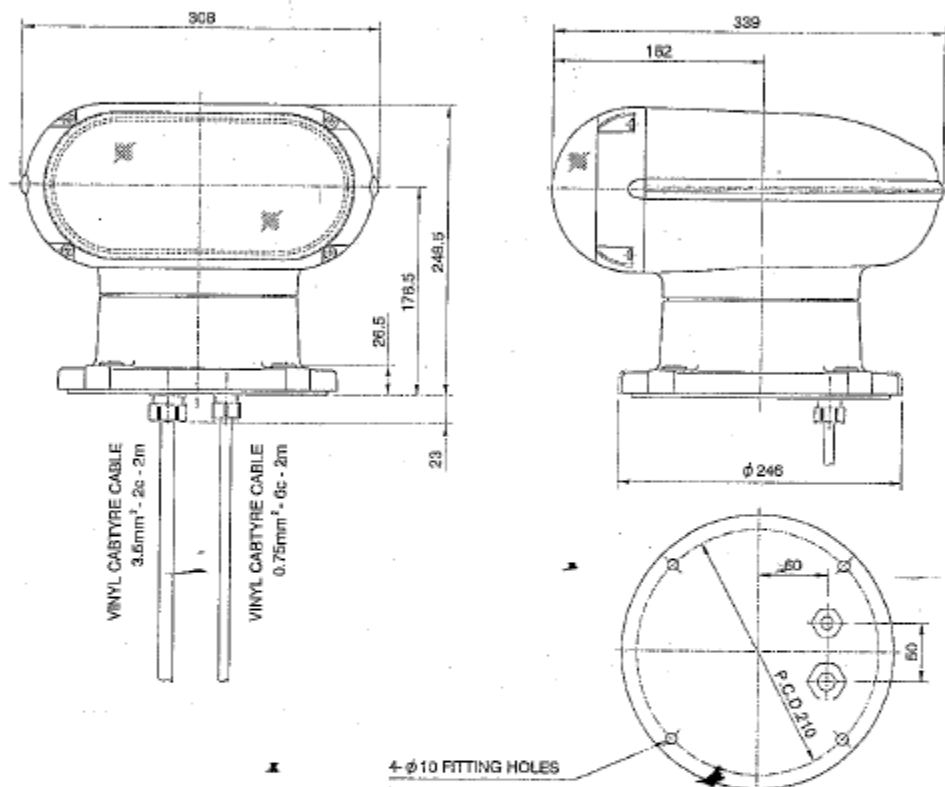

### SPECIFICATIONS

Lamp Housing Materials	Aluminium Alloy Die Casting
	Aluminium Alloy Casting
Base Materials	Aluminium Alloy Die Casting
Reflector	High Quality Parabolic Glass
Applicable Lamp	SCB-0155
Built-in Ballast	24V-8H
Input Voltage	DC 12 V / DC 24 V
Input Current	About 1.5 A (12V) / 4 A (24V)

Peak Beam Candle Power	600,000 cd
Beam Spread	About 7°
Operation Method	Electric Remote Control
Elevation Angle	Up 15°, Down 30°
Turning Angle	360 (Endless)
Elevation Speed	UP About 7 deg / sec. DOWN About 8 deg / sec.
Turning Speed	High About 30 deg / sec. Low About 11 deg / sec.
Degree of Protection	IP56